



DECLARATION OF CONFORMITY IN ACCORDANCE WITH REGULATION (EU) 2023/988

TO WHOM IT MAY CONCERN:

Since the cosmetics sector is in fact regulated at European level by Regulation 1223/2009, and subsequent regulatory provisions, which contain the same objectives set out in Regulation (EU) 2023/988 on product safety, the application of which would start on 13/12/2024, no obligations other than those already present and implemented by the undersigned are foreseen.

Therefore:

M.MAGI SRL, in the responsible person, Giorgio Zunino, with registered office and operational headquarters in  
VIA DELLA BOTTE 18 A/B, 31030 ALTIVOLE TV – ITALY

DECLARES

- as a manufacturer, to comply with all the requirements introduced by the GPSR
- all the products supplied comply with the obligations established in the GPSR.

Furthermore:

Starting from 13/12/2024 any specific information in relation to the provisions of Regulation (EU) 2023/998 on the general safety of "GPSR" products, can be obtained from the website [www.mmagi.it](http://www.mmagi.it) by consulting the relevant product sheet.

In Faith

M.MAGI SRL  
GIORGIO ZUNINO - RESPONSIBLE PERSON

Altivole, 14 Novembre 2024

**Regulation (EU) 2023/998 on the general safety of products "GPSR"**

Given that the cosmetics sector is in fact regulated at European level by EU Regulation 1223/2009 and its subsequent regulatory provisions, which contain the same objectives set out in the regulation in question on product safety, the application of which starts on 13 December 2024, no obligations other than those already in place and implemented by M.MAGI SRL are foreseen.

However, M.MAGI SRL wishes to point out and recommend:

- **The most** effective way to check the quality of a cosmetic product and your individual safety is to read the list of ingredients on the label. The description of the components is done following an international standard: the INCI (International Nomenclature of Cosmetic Ingredients).
- **Carefully** read the indications and instructions printed on the package, on any leaflet, on any manual for use by the beauty operator, or on the website [www.mmagi.it](http://www.mmagi.it).

**PRODUCT FOR EXTERNAL USE – IT IS NOT A FOOD - DO NOT INGEST -  
KEEP OUT OF REACH OF CHILDREN**

- **Product** beauty mask for the face in powder form for the creation of a gel after having added it with 25 ml of water. It is contained in 30 solid gelatin capsules in a PET bottle with a safety seal closure, with a measuring cup placed on the closing cap of the bottle and a mixing paddle inside the case that also contains the bottle.
- **External** use.
- **Product** intended for Professional use by an adult audience: keep away from children.
- **Apply** the product to healthy skin, therefore not damaged, free from wounds, abrasions and burns.
- **It** is advisable to carry out a simple test before using the product on the face, especially for the most sensitive subjects, testing the product on a small portion of skin, on the forearm or neck, and wait the following 24 hours to ascertain any allergic reactions.
- **If** the product should inadvertently come into contact with the eyes and/or mucous membranes, rinse the affected area thoroughly with fresh water.
- **If** due to some incorrect maneuver the product should be inadvertently ingested, go to a poison center of a hospital with the composition/ingredients of the product, printed on each primary or secondary package. In the absence of hospitals, induce vomiting.

- **Preparation and Use** of the mask. As depicted in the images below

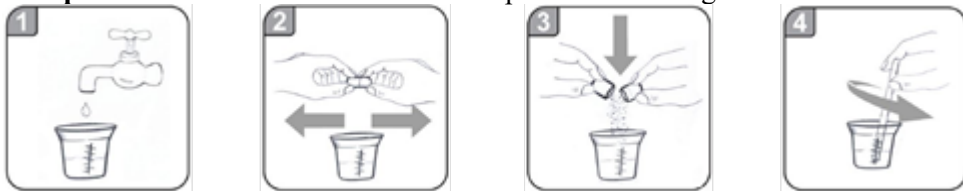

in the small glass provided, placed on the cap of the PET container bottle, add 25 ml of water on which you pour the powder contained in a cap, opening it by pulling the two ends in opposite directions. Mix until you obtain the gel mask that will be applied and left on the face for 15 minutes, after which it will be removed with damp sponges and a light massage will be performed until the product is completely absorbed. Then apply a thin layer of a specific cream.



Italian cosmetics for well-being

- **After** forming the mask as described above, apply it to the face and leave it on the face for at least 15 minutes. Then carefully remove it from the face using sponges slightly dampened with water at room temperature or slightly warm.
- **Do** not exceed the times and quantities of product to be applied, in relation to the type of skin, indicated.
- **Take** care to close the container well after use, so as not to create oxidation or contamination of the product.
- **The** PAO rules do not apply to the product as it is disposable, for one single treatment application.